

LP-TOTAAL  
Vergelijkingsvlak:  
70.00m T.A.W.

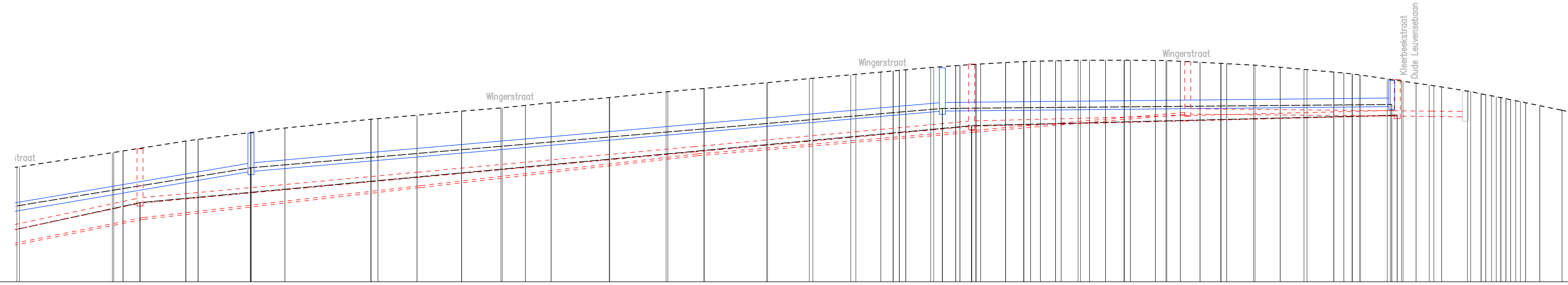

| Profielnummer | Tussenafstand | Bestaand maaveld | Ontworpen hoogte |
|---------------|---------------|------------------|------------------|
|               | 21.74         | 26.06            |                  |
|               | 76.14         | 26.14            |                  |
|               | 14.68         | 26.61            |                  |
|               | 76.68         | 26.68            |                  |
|               | 12.25         | 27.01            |                  |
|               | 7.90          | 27.22            |                  |
|               | 20.08         | 27.63            |                  |
|               | 77.63         | 27.66            |                  |
|               | 9.14          | 27.82            |                  |
|               | 10.48         | 28.01            |                  |
|               | 9.19          | 28.16            |                  |
|               | 5.45          | 28.28            |                  |
|               | 6.03          | 28.40            |                  |
|               | 13.60         | 28.64            |                  |
|               | 13.21         | 28.91            |                  |
|               | 8.42          | 29.07            |                  |
|               | 14.54         | 29.34            |                  |
|               | 9.90          | 29.54            |                  |
|               | 8.89          | 29.71            |                  |
|               | 5.85          | 29.84            |                  |
|               | 2.86          | 29.91            |                  |
|               | 1.34          | 29.95            |                  |
|               | 5.85          | 80.05            |                  |
|               | 5.17          | 80.14            |                  |
|               | 3.65          | 80.21            |                  |
|               | 1.01          | 80.22            |                  |
|               | 5.85          | 80.29            |                  |
|               | 4.20          | 80.33            |                  |
|               | 1.54          | 80.35            |                  |
|               | 2.31          | 80.35            |                  |
|               | 3.54          | 80.36            |                  |
|               | 3.98          | 80.39            |                  |
|               | 2.12          | 80.40            |                  |
|               | 3.73          | 80.40            |                  |
|               | 4.34          | 80.40            |                  |
|               | 1.39          | 80.30            |                  |
|               | 5.85          | 80.39            |                  |
|               | 2.47          | 80.38            |                  |
|               | 3.18          | 80.35            |                  |
|               | 4.60          | 80.30            |                  |
|               | 4.82          | 80.29            |                  |
|               | 1.30          | 80.29            |                  |
|               | 6.27          | 80.17            |                  |
|               | 5.90          | 80.06            |                  |
|               | 5.56          | 79.97            |                  |
|               | 6.27          | 79.84            |                  |
|               | 2.36          | 79.32            |                  |
|               | 3.05          | 79.23            |                  |
|               | 3.09          | 79.14            |                  |
|               | 1.84          | 79.14            |                  |
|               | 6.03          | 78.95            |                  |
|               | 2.45          | 78.82            |                  |
|               | 1.15          | 78.74            |                  |
|               | 1.07          | 78.74            |                  |
|               | 1.72          | 78.74            |                  |
|               | 1.22          | 78.74            |                  |
|               | 3.34          | 78.26            |                  |
|               | 5.18          | 78.05            |                  |
|               | 2.52          | 77.92            |                  |

| PERSLEID. | Tussenafstand                        | Hellingen en ø | Bodemhoogte | Max. hydraul. peil | Legkarakteristieken |
|-----------|--------------------------------------|----------------|-------------|--------------------|---------------------|
|           | G/G--Perleiding--HDPE--DU90--524.00m |                |             |                    |                     |
|           | G/G--Perleiding--HDPE--DU90--524.00m |                |             |                    |                     |
|           | P7--G/G                              |                |             | ø250--2.0mm/m      |                     |
|           | G/G--Deel07--66.00m                  |                |             |                    |                     |
|           | Best.IP2--G/G                        |                |             |                    |                     |
|           |                                      |                |             |                    | 77.87               |
|           |                                      |                |             |                    | 77.74               |

LIGGINGSPLAN  
Schaal : 1/10.000

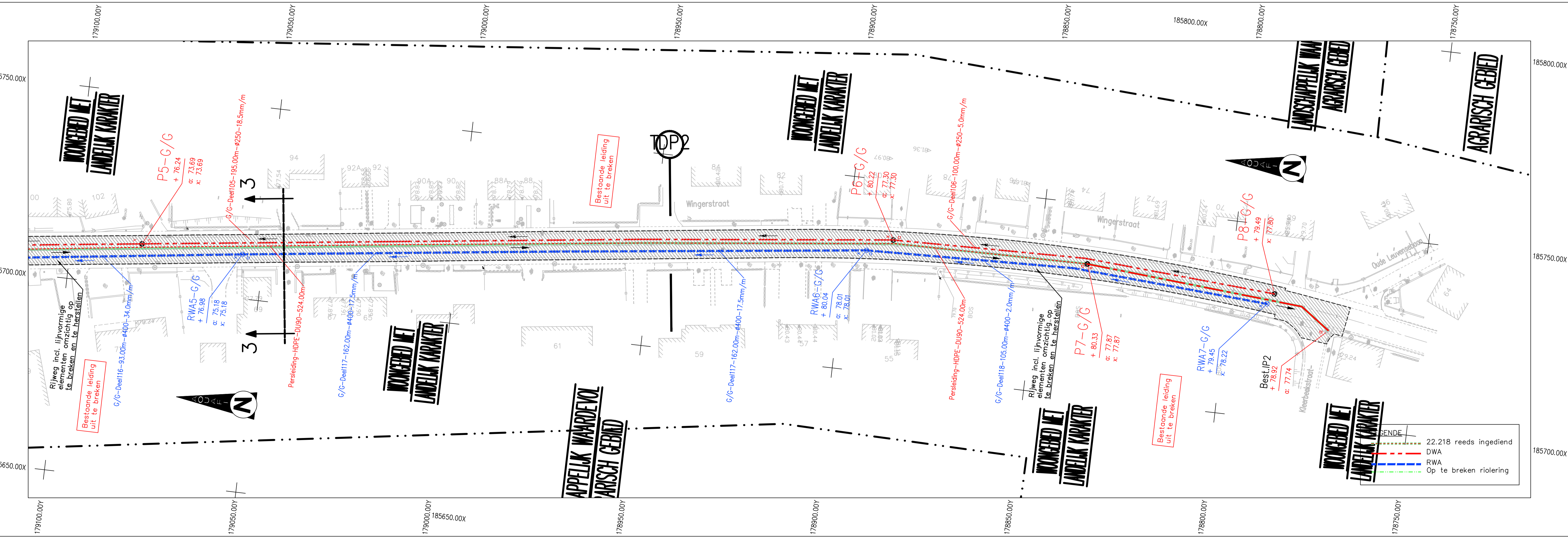
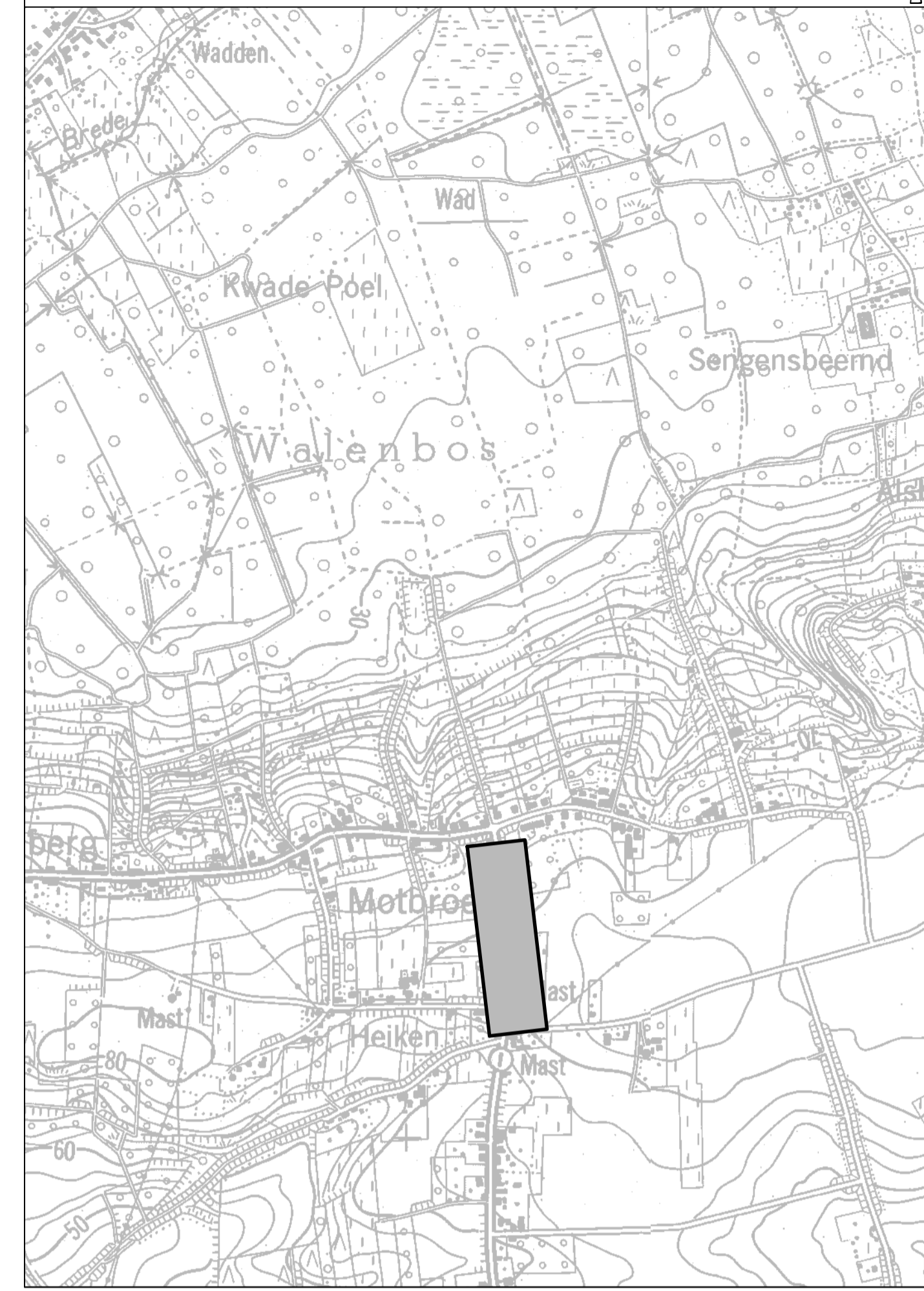

|    |            |                         |
|----|------------|-------------------------|
| 1  | 23.09.2020 | Indiening Ontwerpfase 1 |
| Nr | Datum      | Historiek               |

|   |   |
|---|---|
| <br>Dijkstraat 8<br>2630 Aartselaar<br>Tel.: 03 450 45 11<br>Fax.: 03 458 30 20 | Provincie : VLAAMS-BRABANT<br>Stad/Gemeente : TIELT-WINGE   |
|   | Projectnummer : 22.218V<br>Projectnaam : AANSLUITING KWZI WALENBOS  |
| Nummer : 22.218V/01/10<br>01-01.04a/06  | Titel : ONTWERPPLAN RIOLERINGS-<br>EN COLLECTORWERKEN<br>Wingerstraat   |
| NV Aquafin<br>Gezien en goedgekeurd   | Studiebureau<br><br>vestiging Hasselt<br>Herkenodsingel 8B, bus 3.01<br>B-3500 Hasselt<br>T +32 11 26 08 70<br>F +32 11 26 08 80<br>www.swecobelgium.be |
| Aannemer<br>Ing. Jan Vanderstraeten<br>Projectleider<br>Ing. Tine Thoron        | Stad/Gemeente<br>Schaal:<br>1/500<br>1/100<br>Opp:<br>06.3m²<br>Dossier nr.<br>100925   |